

**HAYWARD®**

# GLX-PCB-ONCOM

(Replacement Instructions)

**WARNING:** Before attempting to install the replacement GLX-PCB-ONCOM, remove input power to the On-Command.

When the main printed circuit board (PCB) is replaced, all of the configuration settings will be lost. You may want to record your pool settings before removing the PCB.

To install the GLX-PCB-ONCOM, the display panel should first be removed for easier access. Follow the steps below for panel removal and then continue to the back page for instructions on how to replace the main PCB.

- 1) Open door and remove the 2 screws holding the panel in place.

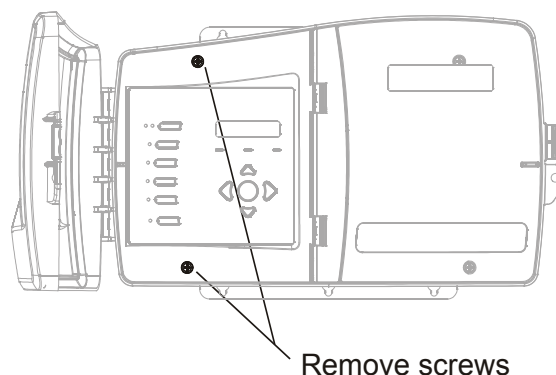

- 2) Swing panel open and disconnect the four conductor cable from the main PCB.

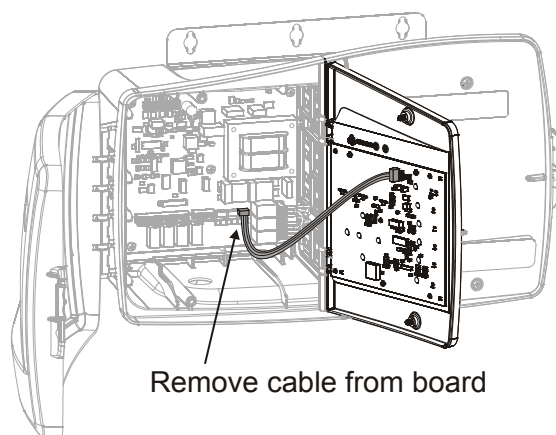

Hayward Industries  
400 Connell Drive, Suite 6100  
Berkeley Heights, NJ 07922  
Phone: (908) 355-7995  
[www.hayward.com](http://www.hayward.com)



- 3) Continue to swing panel open until pressure is felt on the hinges. Gently continue to push until the panel releases from the hinges. Remove panel.

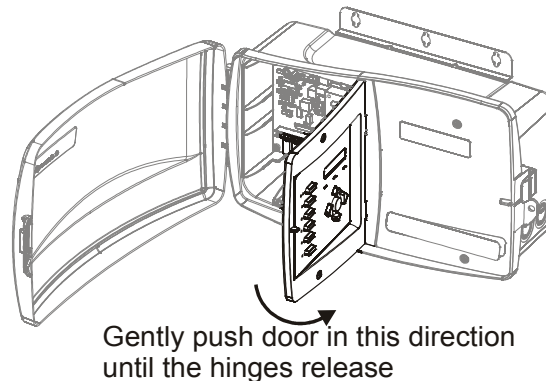

- 4) Disconnect relay connector located at the top of the PCB. Disconnect all other connections to the PCB (input wiring, sensors, etc.).

Disconnect the relay control wiring

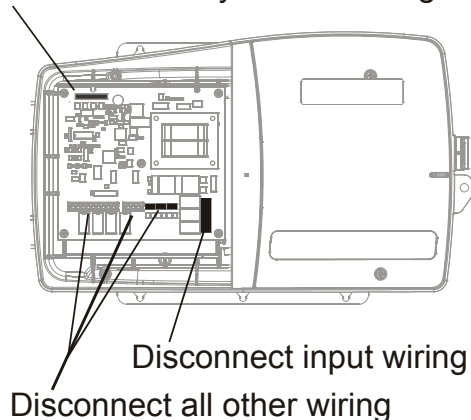

- 5) Remove the five screws holding the PCB in place.

Remove the  
5 mounting screws

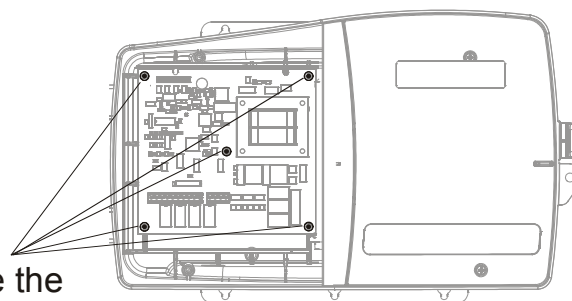

- 6) Remove PCB from enclosure.
- 7) Reverse steps 1-6 to install the new GLX-PCB-ONCOM.
- 8) The new PCB will have to be reprogrammed to operate your system. Refer to the OnCommand Installation manual for detailed information.

Hayward Industries  
400 Connell Drive, Suite 6100  
Berkeley Heights, NJ 07922  
Phone: (908) 355-7995  
[www.hayward.com](http://www.hayward.com)